

## First Stamford Place Conference Center

The Conference Center is located on the first floor lobby in Building 100.

- One large conference room available for rent to accommodate socially distanced seating for a maximum of up to 18 persons.
- Three (3) different layout options which allow for the required social distancing.
- High performance air filtration (MERV-13)
- AtmosAir bipolar ionization air purification system
- Enhanced cleaning (green whenever possible and proven CDC approved disinfection for COVID-19).
- High Speed Wi-Fi.
- Whiteboard for use in training sessions.
- Projector and screen setup available.
- Catering available upon request.

The Conference Center is available to all tenants and can be reserved up to 24 hours in advance via the Workspeed system. When creating reservation, click **Shared Resources** —→ **Conference Center**. The conference rooms may be reserved for full day increments. The configuration/layout type should be included in the Workspeed reservation. Rates are \$425 per day.

All room rentals reservations must be cancelled within 24 hours to avoid being charged the rental fee.

Should you have any questions please contact Cathy DeRose at [cderose@empirestaterealtytrust.com](mailto:cderose@empirestaterealtytrust.com).

Be Smart. Be Safe.

# FIRST STAMFORD PLACE

THE CAMPUS BY THE TRAIN

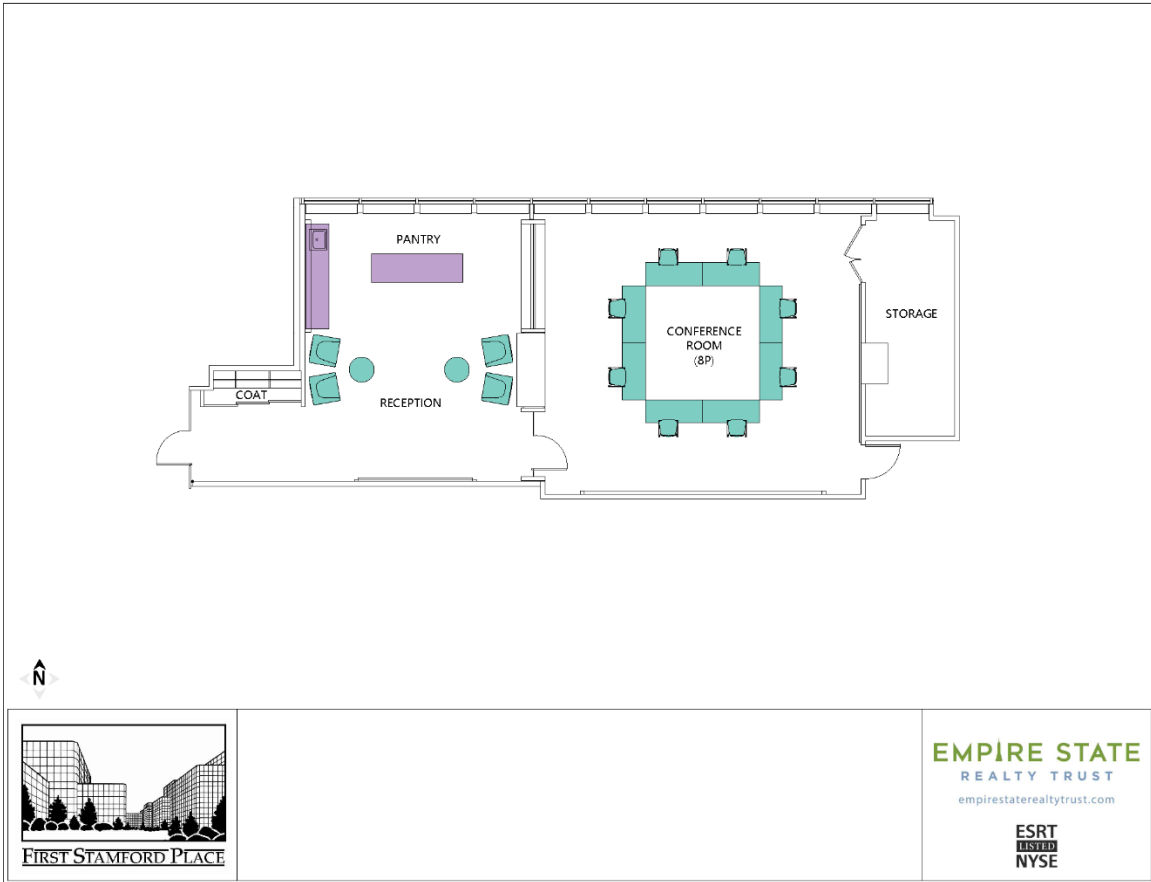

**EMPIRE STATE**  
REALTY TRUST  
[empirestaterealtytrust.com](http://empirestaterealtytrust.com)

**ESRT**  
LISTED  
NYSE

# FIRST STAMFORD PLACE

THE CAMPUS BY THE TRAIN

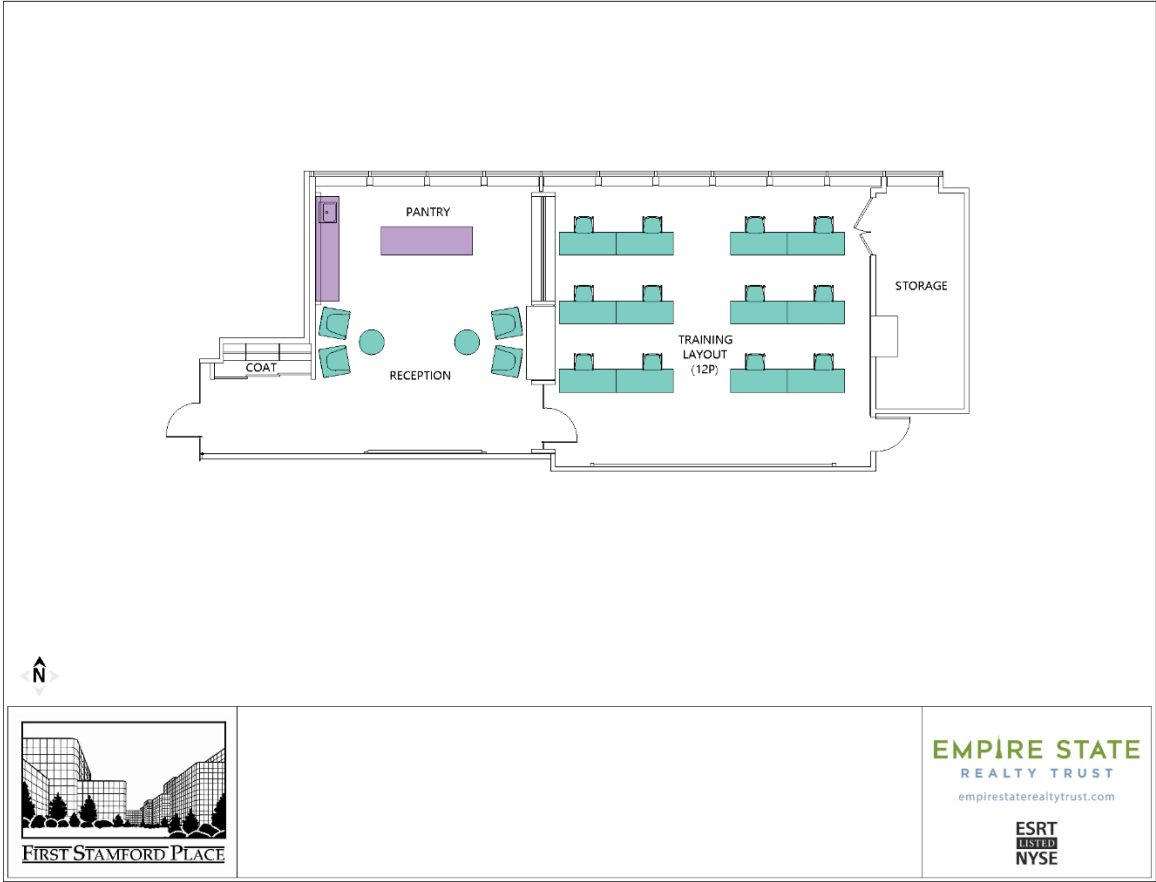

# FIRST STAMFORD PLACE

THE CAMPUS BY THE TRAIN

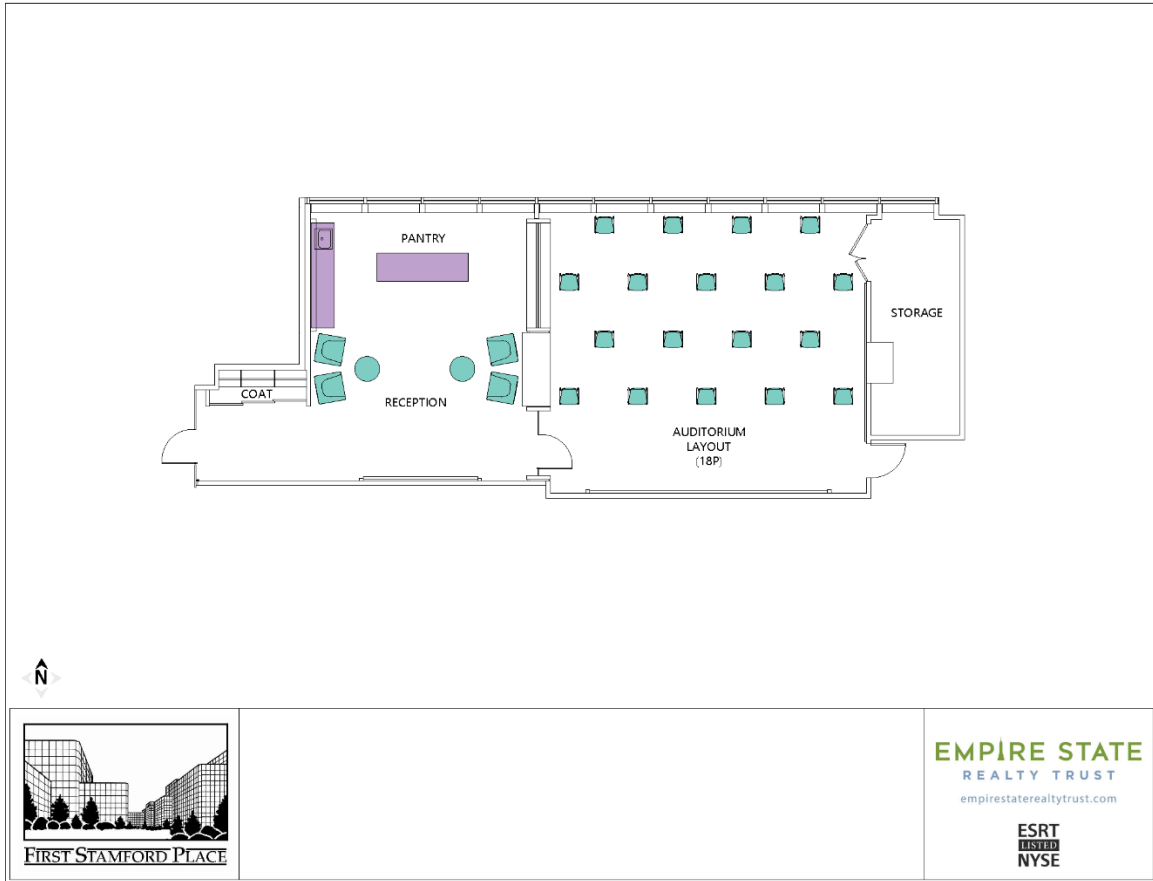

**EMPIRE STATE**  
REALTY TRUST  
[empirestaterealtytrust.com](http://empirestaterealtytrust.com)

**ESRT**  
LISTED  
NYSE